

Streetview Rotating Installation Instructions

For information call (919) 304-3973

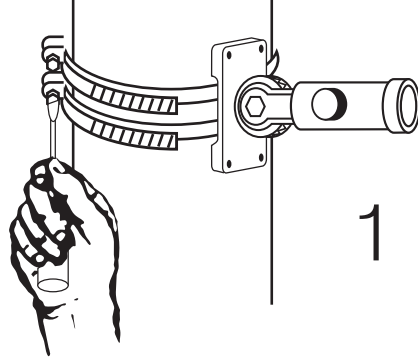

1 Secure upper bracket using the supplied adjustable stainless steel straps

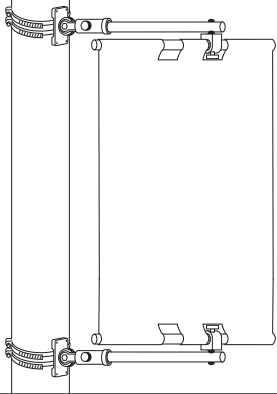
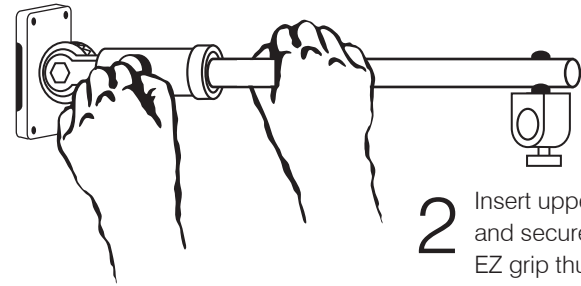
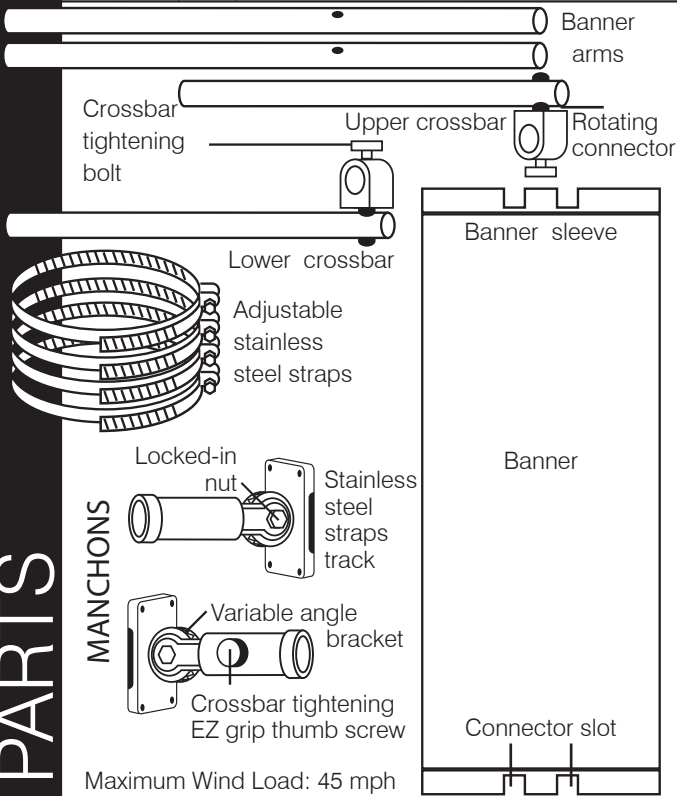

2 Insert upper crossbar in bracket and secure it by tightening the EZ grip thumb nut

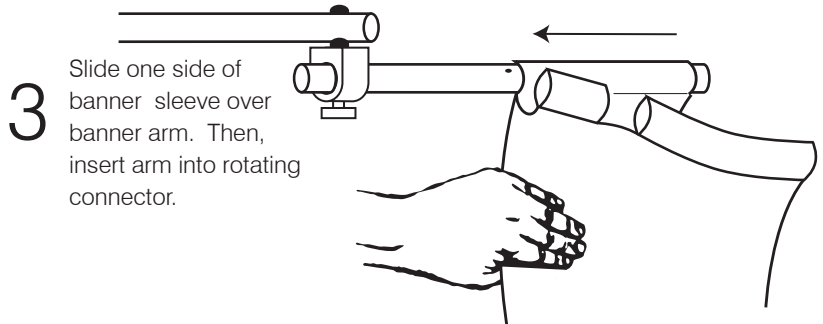

3 Slide one side of banner sleeve over banner arm. Then, insert arm into rotating connector.

4 Pull banner connector slot over connector. Slide banner arm in banner sleeve's middle and opposite section. Align banner arm hole with tightening bolt, and secure banner arm.

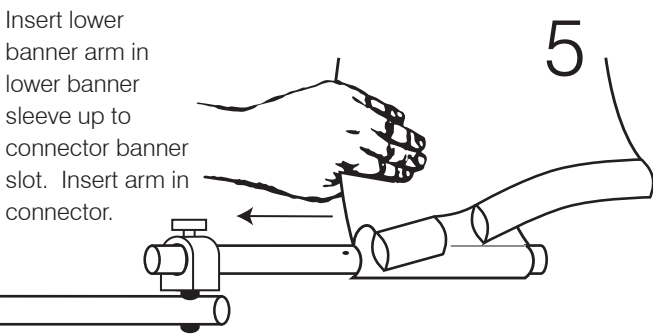
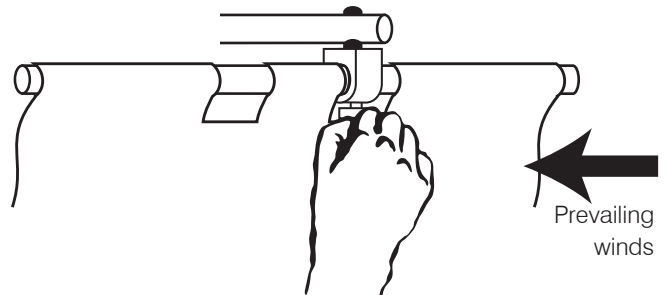

5 Insert lower banner arm in lower banner sleeve up to connector banner slot. Insert arm in connector.

ATTENTION: when using one-sided banners, position banners so that rotating connector is on the side of prevailing winds to ensure that banners are readable.

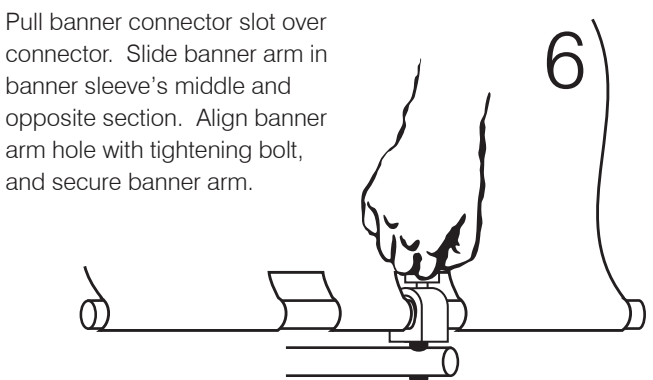

6 Pull banner connector slot over connector. Slide banner arm in banner sleeve's middle and opposite section. Align banner arm hole with tightening bolt, and secure banner arm.

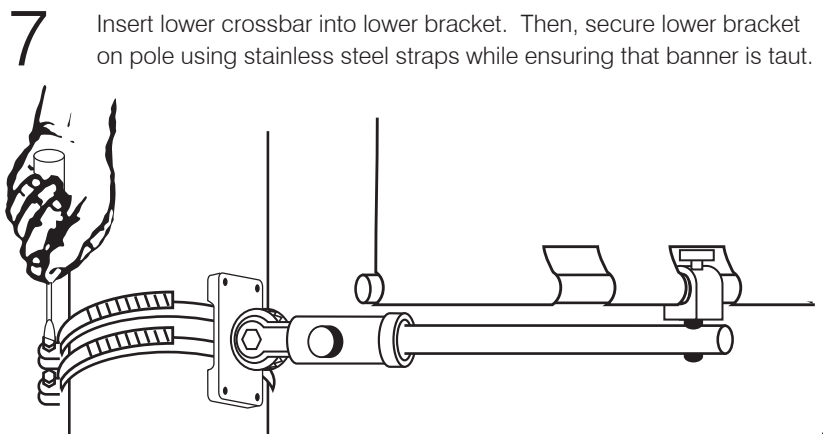

7 Insert lower crossbar into lower bracket. Then, secure lower bracket on pole using stainless steel straps while ensuring that banner is taut.